

When mounted on the Veritas® Low-Angle or Standard Block Plane the chamfer guide facilitates the cutting of accurate and consistent 45° chamfers. The guide is easily adjusted with a screwdriver and allows for chamfers up to 1/2".

Setting the Size of Chamfer

The chamfer guide should be set to the desired chamfer size (from 0" to 1/2") before installing it on the block plane. Loosen the two screws and move the adjustable guide to the desired position. The lines extruded on the underside of the body provide a reference for positioning the adjustable guide so that it is parallel to the fixed guide. Finer settings may be achieved by varying the depth of cut on the plane blade.

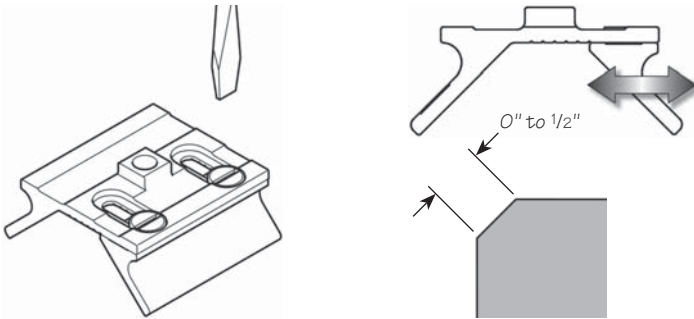

Installation

The chamfer guide is easily and quickly installed. Simply unscrew the front knob and remove the toe piece from the block plane. Position the chamfer guide in the toe pocket and secure with the front knob. To set the mouth opening, loosen the front knob and move the chamfer guide forward or backward to achieve the desired distance from the blade, then tighten the front knob.

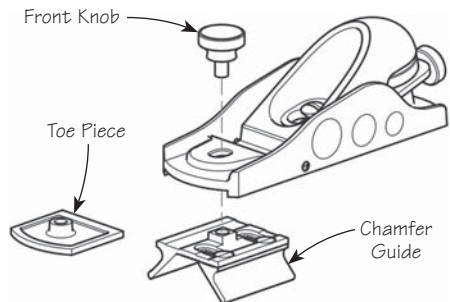

Shims

Three colored shims have been included with the chamfer guide. The purple shim is 0.005" thick, the blue shim is 0.010" thick, and the black shim is 0.020" thick. Install as many shims as needed on the chamfer guide to bring it in line with the sole of the plane.

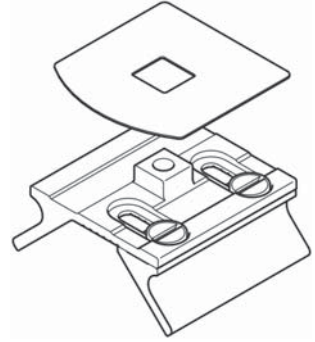

Instructions

To start the cut, set the plane so one edge of the guide rests on the workpiece. Keep planing until both edges of the chamfer guide come in contact with the workpiece. At this point the desired chamfer has been achieved and the plane will no longer be removing any wood.

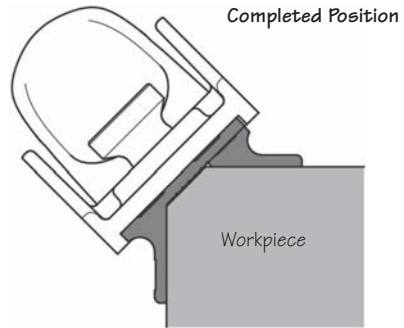
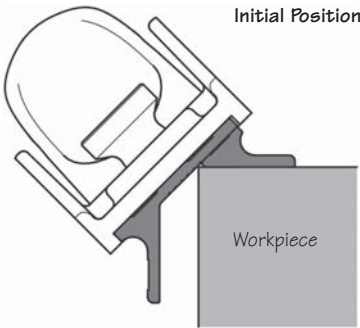

While this set-up is best for chamfering with the grain, the low cutting angle of the Veritas Low-Angle Block Plane also makes it possible to chamfer end grain.